

TOWNSHIP 3 N., RANGE 8 W.W.M. TILLAMOOK COUNTY ORE.

SCALE 2 IN. = 1 MILE.

CHAS. F. METSKER CIVIL ENGINEER
514 S.W. OAK STREET, PORTLAND, ORE.
111 50-TENTH STREET, TACOMA, WASH.

1-AXEL ERICKSON
2-COUNTY

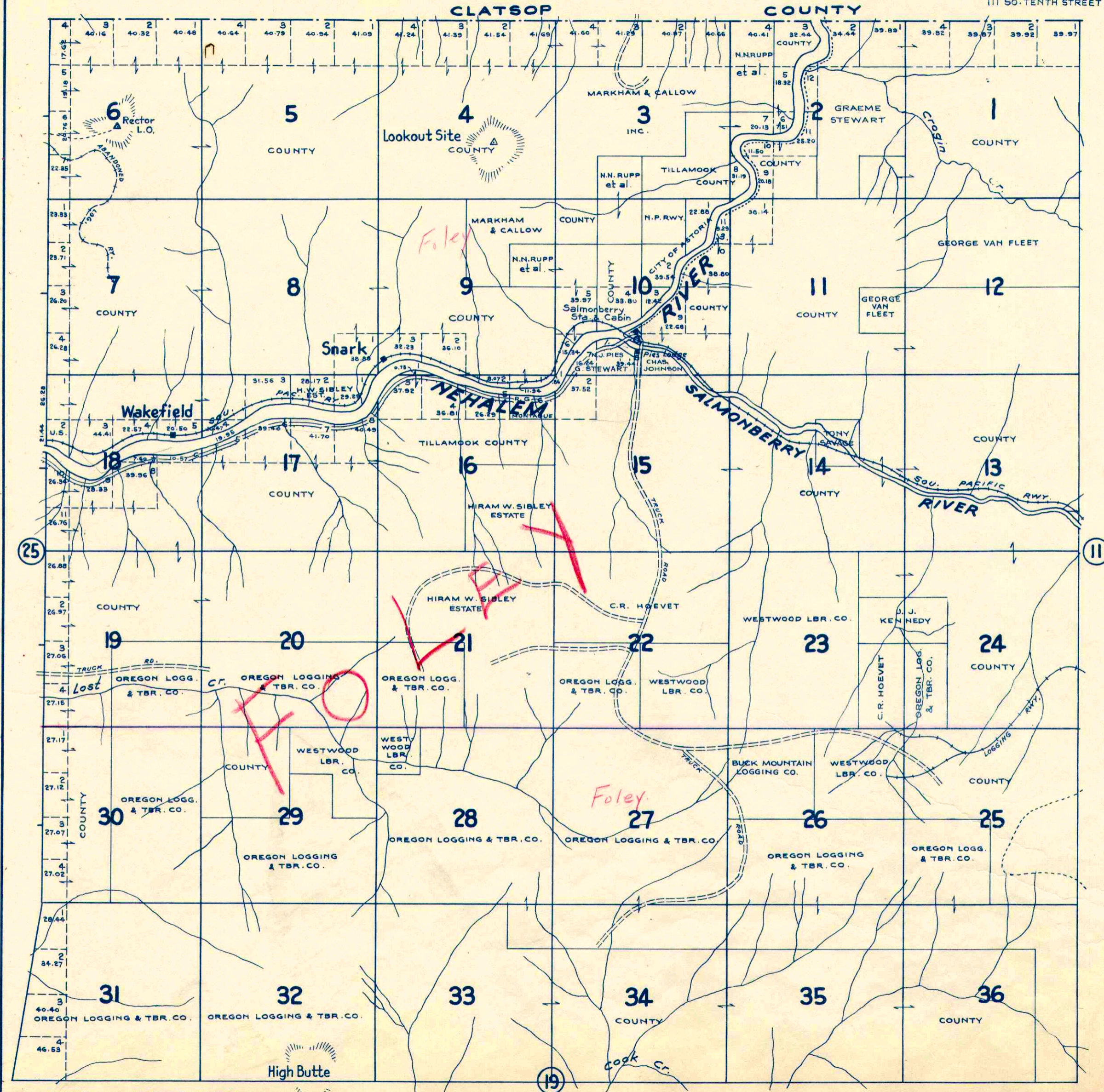

— LEGEND —

PAVED ROADS	
IMPROVED DIRT ROADS	
OTHER ROADS	
TRAILS	
RAILROADS	
ELE. RWYS	
SCHOOLS	